

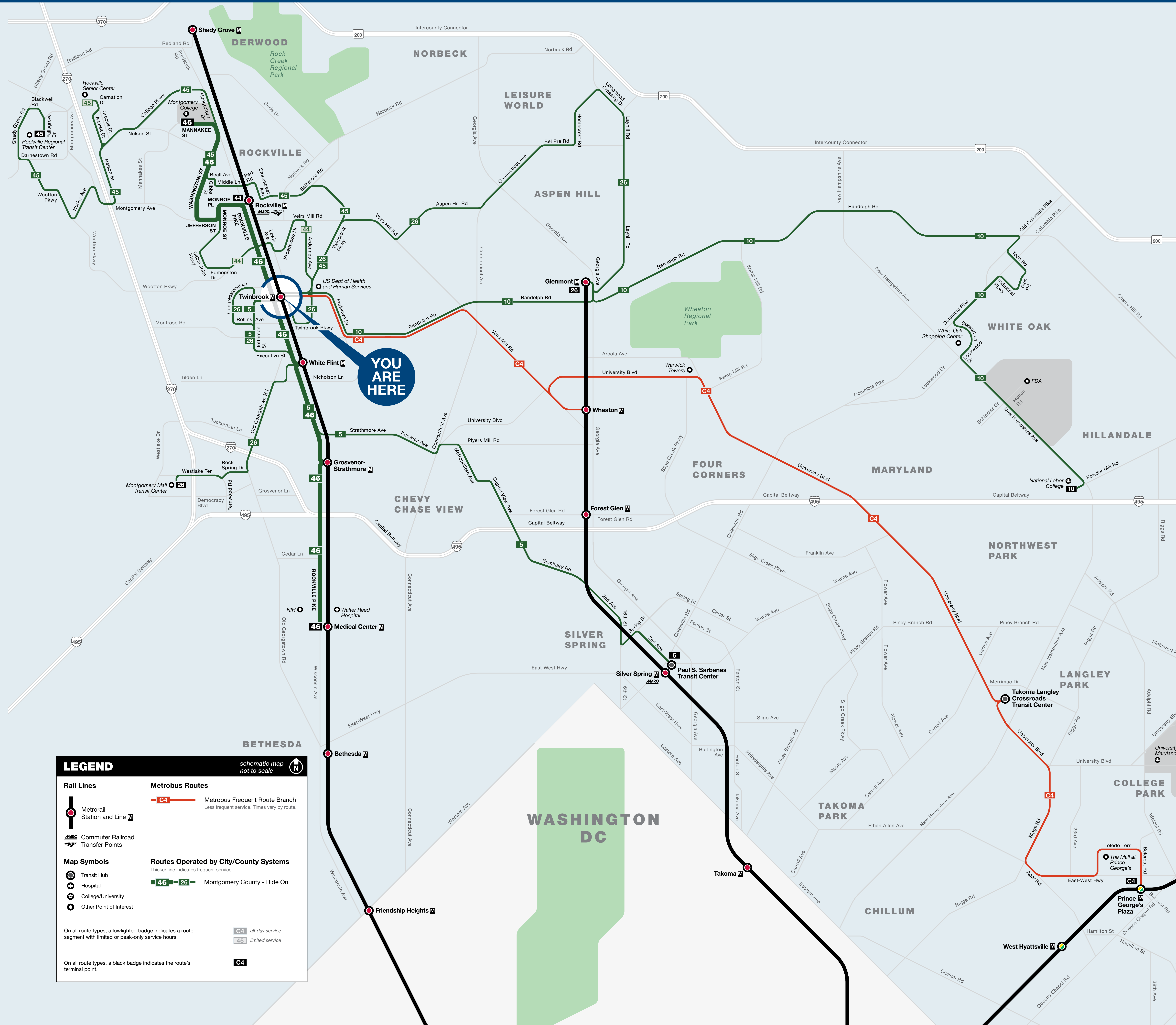

# Bus Service from Twinbrook



## BUS SERVICE AND BOARDING LOCATIONS

The table shows approximate minutes between buses; check schedules for full details

### EASTSIDE

ROUTE	DESTINATION	BOARD AT BUS BAY	MONDAY TO FRIDAY				SATURDAY		SUNDAY	
			AM RUSH	MIDDAY	PM RUSH	EVENING	DAY	EVENING	DAY	EVENING
<b>GREENBELT-TWINBROOK LINE</b>										
<b>C4</b>	Prince George's Plaza <b>M</b>	<b>A</b>	24	20-24	16-20	24-30	24	24-30	12	12-30
<b>RIDE ON-MONTGOMERY COUNTY</b>										
<b>10</b>	Hillandale	<b>B</b>	30	20-25	25	30-45	30	30-40	40	40
<b>26</b>	Glenmont <b>M</b>	<b>C</b>	20-25	25	20	25-45	30	35-45	30	35-45
<b>26</b>	Montgomery Mall Transit Center	<b>C</b>	20	25-30	20	35-45	35	35-45	35	35-45
<b>44</b>	Rockville <b>M</b>	<b>E</b>	50	--	50	--	--	--	--	--
<b>45</b>	Rockville Regional Transit Center	<b>E</b>	25-35	35*	25-30	35	45	--	--	--

\* Certain midday trips serve Rockville Senior Center. No service to Rockville Senior Center on Saturdays.

### WESTSIDE

ROUTE	DESTINATION	BOARD AT BUS BAY	MONDAY TO FRIDAY				SATURDAY		SUNDAY	
			AM RUSH	MIDDAY	PM RUSH	EVENING	DAY	EVENING	DAY	EVENING
<b>RIDE ON-MONTGOMERY COUNTY</b>										
<b>5</b>	Paul S. Sarbanes Transit Center (Silver Spring <b>M</b> )	<b>B</b>	20	20-35*	15-30	30-40	40*	40	40*	40
<b>26</b>	Glenmont <b>M</b>	<b>E</b>	20-25	25	20	25-45	30	35-45	30	35-45
<b>26</b>	Montgomery Mall Transit Center	<b>D</b>	20	25-30	20	35-45	35	35-45	35	35-45
<b>46</b>	Medical Center <b>M</b>	<b>A</b>	20	15-20	15	20-40	25-35	30-40	30-40	40
<b>46</b>	Montgomery College	<b>A</b>	20	15-20	15	20-40	25-35	30-40	30-40	40

**M** Metrobus **SHUTTLE** **C** During track work and/or rail shutdown events, this bus stop will also be served by Metro shuttle buses.

\* Certain Route 5 trips serve Victory Forest. See full schedule for details.  
Ride On Route 26 serves Bus Bay C on the eastside of Twinbrook station.

### BUS BOARDING MAP

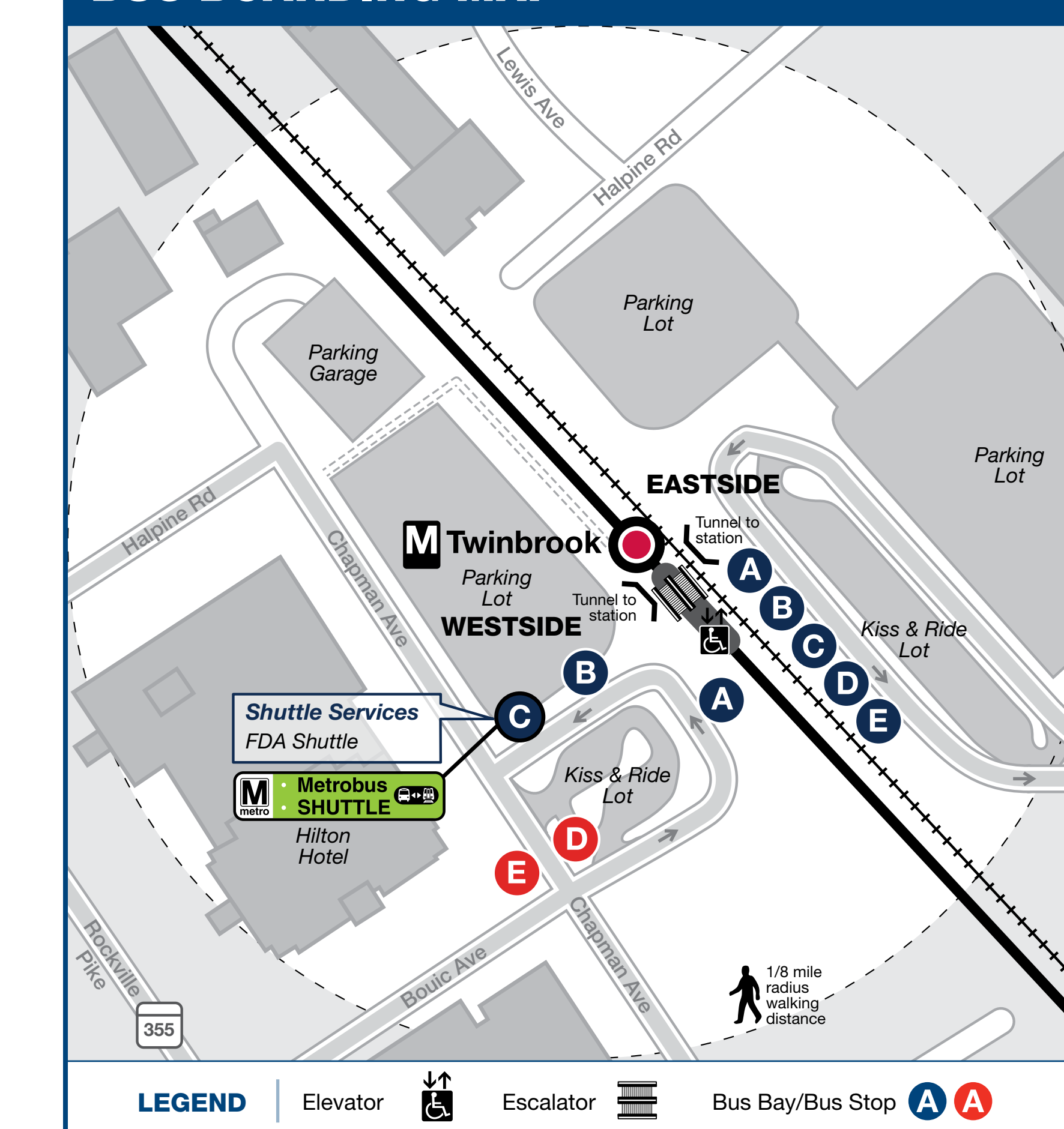

Bus service is subject to change. Check [wmata.com](http://wmata.com) for updates.

## metroAlerts

Through MetroAlerts, you can be notified of Metro service disruptions via email or text messages. MetroAlerts can be sent to computers, cellular phones, pagers or personal digital assistants capable of receiving data. MetroAlerts are limited to 140 characters to prevent them from being truncated when received as text messages. If further information on the incident is available, it is published on the website and a link to that information is included in the MetroAlert.

**KNOW MORE. KNOW FIRST.**  
Sign up today at [wmata.com/MetroAlerts](http://wmata.com/MetroAlerts)

information [wmata.com](http://wmata.com) | 202-637-7000 | 202-638-3780

busETA and General Inquiries

Para busETA y información general, llame al 202-637-7000 (TTY 202-638-3780) o visite [wmata.com](http://wmata.com).

정보나 busETA 또는 언어 지원 관련 문의는 202-637-7000 (TTY 202-638-3780) 으로 전화하십시오. 스페어 언어 문의는 T를 누르고, 기타 언어 관련 문의는 88을 누른 후 5를 누르십시오. 또는 [wmata.com](http://wmata.com) 을 방문하십시오.

**metroAlerts**  
Sign up today at [wmata.com/MetroAlerts](http://wmata.com/MetroAlerts)

Metro is accessible.  
Metro es accesible.  
메트로는 접속 가능합니다.

